



SMART Slate™ wireless slate

When you use the SMART Slate wireless slate, you can interact with digital lessons no matter where you are in the classroom. The SMART Slate enables you to control applications, add notes and highlight information whether you're at the front of the room, the back of the class or by a student's side.



The SMART Slate brings new possibilities to your classroom by giving you and your students the freedom to interact with digital content from anywhere in the room. Use the SMART Slate to control applications, add notes and highlight information, while your work is projected for the whole class to see.

Gain mobility in your teaching

The SMART Slate connects wirelessly to your computer, and has a slim design for easy transport around the classroom as you teach. It enables you to control applications wirelessly, and as you use the pen to write on the slate's surface your handwriting displays on both your computer screen and the SMART Board™ interactive whiteboard or projection screen for the entire class to see.

Complement any classroom

The SMART Slate is versatile – it fits into a variety of technology-enabled classrooms and connects wirelessly to your computer from up to 32' (10 m) away. On its own, the SMART Slate functions easily with a computer and projector. When integrated with a SMART Board interactive whiteboard or SMART Podium™ interactive pen display, the SMART Slate gives you even more ways to shift seamlessly between whole-class, small-group and individual instruction. It gives you the flexibility to involve one student on the interactive whiteboard at the same time as a classmate writes on the SMART Slate.

Engage all students

Reach all the students in your classroom. Write out a math problem using the SMART Slate, and then hand it to students to fill in the answer and their work is visible for the whole class to see. The SMART Slate makes it easier to involve students with limited mobility, giving them the opportunity to solve problems or demonstrate their knowledge from their desks.

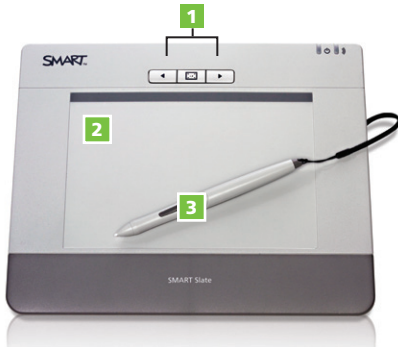

- 1** Programmable buttons
- 2** Active screen area
- 3** Battery-free tethered pen

Specifications

Active area

6 3/4" W x 4 1/4" H
(17.3 x 10.8 cm)

Size

10 3/8" W x 8 1/2" H x 1" D
(26.4 x 21.6 x 2.6 cm)

Weight

1 lb. 4 oz
(600 g)

Key features

Seamless classroom integration

The SMART Slate enables you to wirelessly control your SMART Board interactive whiteboard or SMART Podium interactive pen display, and it is fully compatible with SMART Notebook™ collaborative learning software.

Simultaneous interaction

A student can write on the SMART Board interactive whiteboard at the same time as a classmate writes on the SMART Slate.

Integration with ink-aware applications

The SMART Slate enables you to write and save notes directly into ink-aware applications such as Microsoft® Word, Excel® or PowerPoint®.

Battery-free, tethered pen

The SMART Slate includes a battery-free, tethered pen that is used on the slate's surface to control applications and write in digital ink. The maintenance-free pen also has a programmable button and dedicated eraser.

Printed underlay

With the SMART Slate, you'll have access to printable sheets that fit under the plastic cover of the surface. Each underlay features customizable icons for quick access to tools such as the pen, eraser, right-click or screen capture.

Electromagnetic surface

The 6 3/4" x 4 1/4" (17.3 x 10.8 cm) electromagnetic screen only recognizes the pen as an input, so you can naturally rest your hand on the surface. The active area becomes proportional to any screen size for accurate contact.

Programmable buttons

Easily access your favorite functions by customizing the user-defined buttons. There are three programmable buttons on the SMART Slate and one on the pen.

Rechargeable lithium-ion battery

The SMART Slate's battery allows for 24 hours of continuous use, and has a charge time of 6.5 hours. Charge the battery by attaching it to your computer with the included USB cable. The SMART Slate's power switch ensures that the battery doesn't drain during periods of non-use.

Bluetooth® adapter

The slate's Class 2 Bluetooth adapter has an expected range of 32' (10 m) and a maximum range of 164' (50 m) in free space.

Ergonomic and portable design

The SMART Slate has a small, light form factor for improved ergonomics and easy transport around the classroom.

Kensington security lock

If you need to secure the SMART Slate in a room, the Kensington security lock provides an easy way to attach a lock-and-cable apparatus.

International language support

The SMART Slate supports the following nine languages: English (U.S. and UK), Brazilian Portuguese, Simplified Chinese, French, German, Mexican Spanish, Russian, Arabic and Castilian (European) Spanish.

System requirements

Windows® operating system

Pentium® III 750 MHz processor
512 MB of RAM (1 GB recommended)
250 MB of free hard disk space for minimum installation (1 GB for full installation with Gallery Collections)
Windows XP or Windows Vista® or Windows 7 operating system
Internet Explorer® Internet browser 6.0 or later
Adobe® Flash® Player 8
Microsoft DirectX® application programming interface 8.1 or later (required for SMART Video Player)

Mac support

Mac operating system 1 GHz PowerPC® G4 or G5 processors or Intel processors (universal binary)
512 MB of RAM
250 MB of free hard disk space for minimum installation (1 GB for full installation with Gallery collections)
Mac OS X 10.5.0 operating system software or later
Safari application program 1.3.2 or later
Adobe Flash Player 10 or later
SMART Board Drivers - service pack 10 or later

Authorized reseller:

IT Extra Automatisering
Melisse 14
8313 BC Rutten
Tel: 0527 788800
Mob: 06 50 451415
Uw contact: Niels de Boer
www.it-extra.nl
info@it-extra.nl

SMART Technologies

Toll Free 1.866.518.6791 (U.S./Canada)

or +1.403.228.5940

smarttech.com